

**Minutes of Virtual M S Teams Meeting between M/s AEML and Vehicle Mounted DG Set Bidders for Prebid Meeting against NIT No- AEML/MDB/2021-22/47 on 22.07.2021**

**Member Present:**

<b>AEML</b>	<b>Bidders</b>
1. Umesh Joshi - CES	1. Sanjay Marathe – Powerica Ltd
2. Yogesh B. Deshmukh - CES	2. Ankush Patil – Powerica Ltd
3. Rajendrasing Girase - CES	3. Akshay Tahashildar – Kala Genset
4. Nitin Kumawat -CPG	4. Kalpesh Patil – Kala Genset
5. Nikhil Gupta-CPG	5. Vinit Sharma - Electro-Equipment
6. Milind Patil -Transport	6. Arun Singh – Sea Dogs Pvt Ltd
7. Dnyaneshwar Nikam -Transport	7. Sumit
8. Neelam Sumbrui-Operations	
9. Sandeep Khule -Operations	

Following points were discussed against various bidder's queries in pre-bid meeting. Clarifications to the queries are made as under-

1. 500 kVA DG Set assembly is possible on vehicle; however, 750 kVA DG set cannot be assembled/mounted on vehicle considering CPCB standardization; However, 750 kVA DG can be mounted on trolley. (M/s Powerica Ltd /M/s Kala Genset P Ltd);

AEML Reply – All possible options shall be quoted in bid documents.

2. Requirement / specification about length of vehicle (M/s Kala Genset P Ltd)

AEML Reply – Vehicle shall be compact as much as possible

3. Applications / usage of DG Set - (M/s Kala Genset P Ltd / Electro-Equipment)

AEML Reply – Emergency standby power source in case of 11/0.433 kV Substation equipment failure across Mumbai Distribution area (Eastern and Western Suburbs)

4. Minimum turnover clause clarification (Electro-Equipment)

AEML Reply – All necessary supporting documents needs to be submitted as per PQR.

5. Height of exhaust piping as per MOEF / CPCB guidelines (M/s Kala Genset P Ltd/ Electro-Equipment)

- AEML Reply – Being operational requirement, shall be taken care case to case basis.
6. AEML shall have virtual visit at bidder's works (DG manufacturing and assembly) for registration purpose.
  7. Sample LV panel GA (to be fed from DG ) is attached as Annexure for reference.
  8. Tender fee is not applicable for this tender.
  9. AEML clarifications -
    - i. Mounting and coupling of DG unit on base frame with acoustic enclosure on vehicle chassis included in bidder's scope
    - ii. Supply and connection of single core copper cables including terminations (35 m/phase) included in bidder's scope
    - iii. Customised cable motorised reel shall be provided on DG Set for winding of power cables
    - iv. Energy Meter shall be free issue; Space provision, EM mounting arrangement along with supply of TTB, Modem shall be considered
    - v. Systems for enabling remote monitoring of parameters of DG operation shall be included in scope of supply of DG Set; Local display for all major operational parameters shall be available.
    - vi. Type test reports and other test reports as per prevailing standards /norms/guidelines for all major components viz engine, alternator, vehicle etc. shall be submitted.
    - vii. ITC along with within-warranty services shall be quoted as per tender BoQ
    - viii. Warranty period along with standard coverings shall be clearly mentioned in bid documents considering all major components
    - ix. Explicit confirmations of addendum points in addition to technical specification shall be submitted with technical bid documents.

# Annexure – Reference LV Panel GA

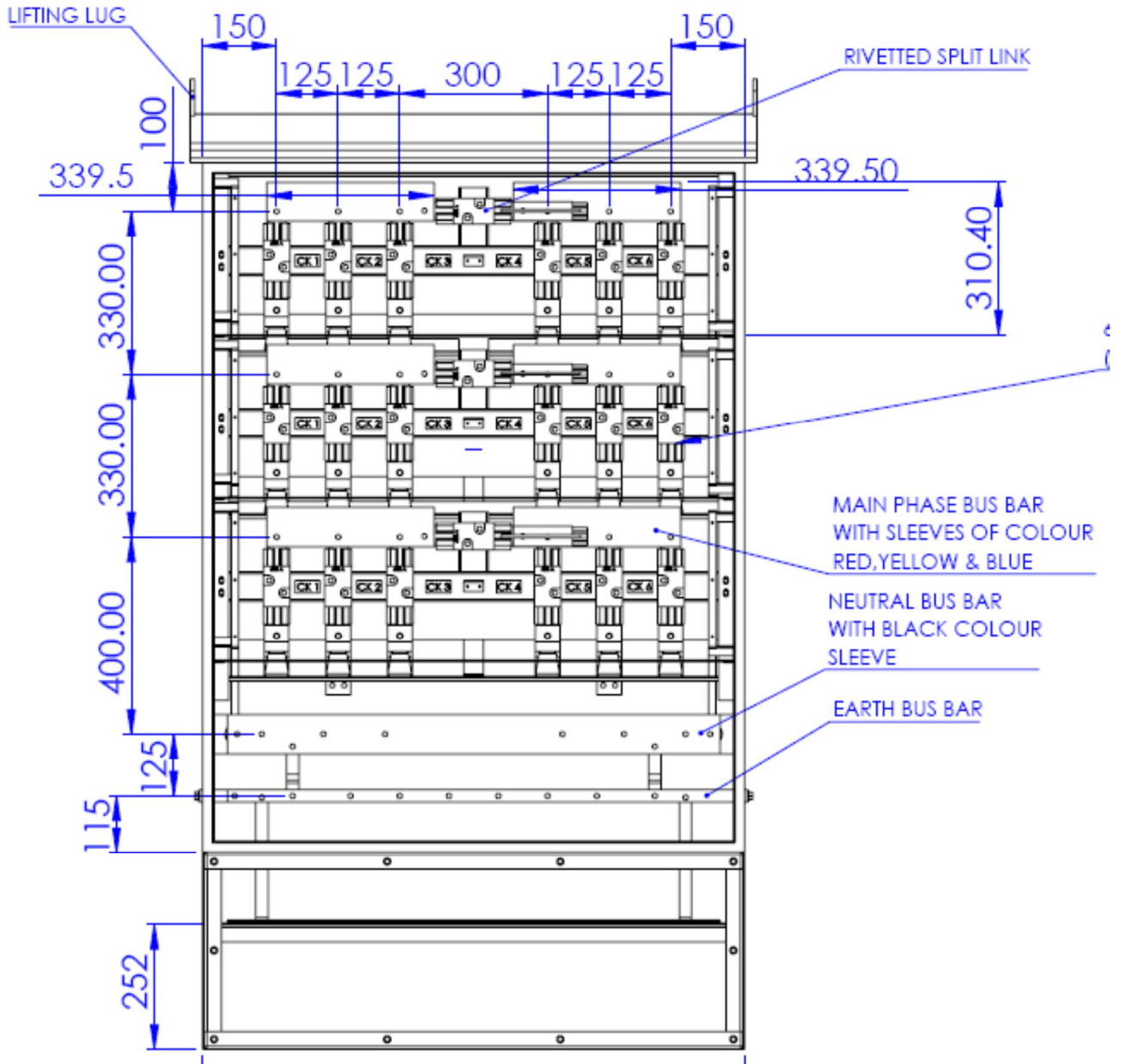

# Annexure – Reference LV Panel GA

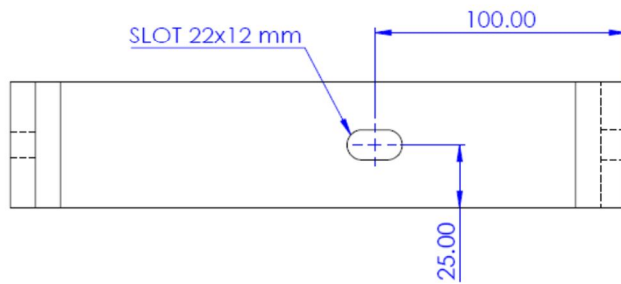
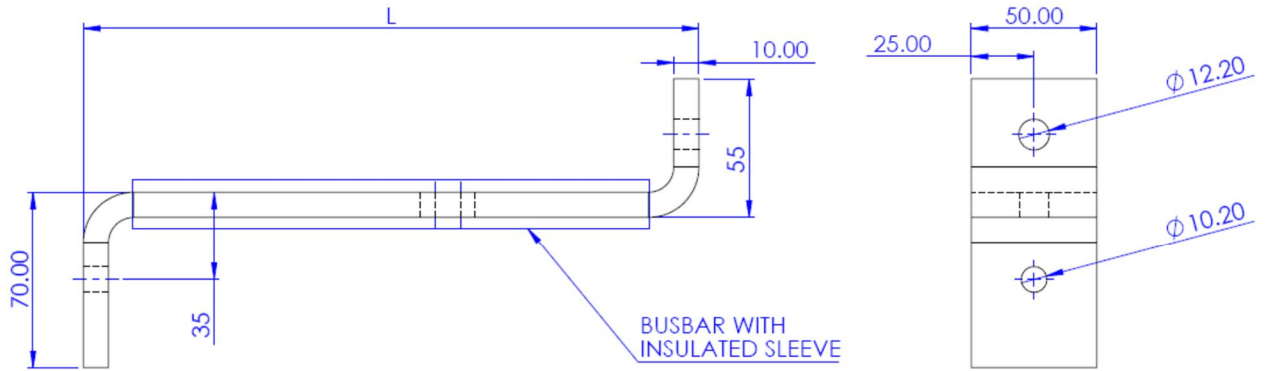
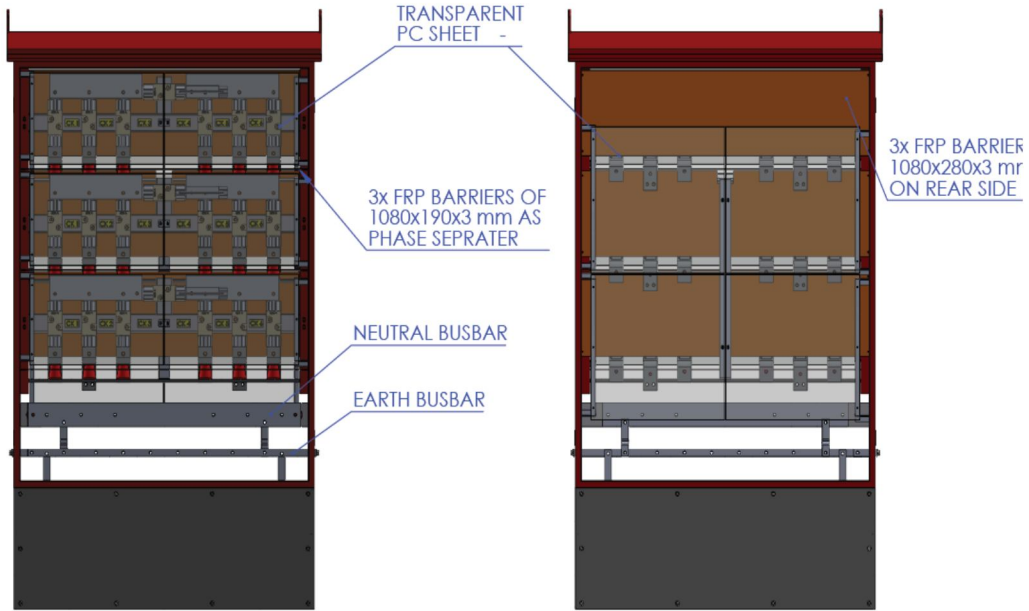

	R	Y	B
LENGTH	245	220	195
COLOUR	RED	YELLOW	BLUE

**Z STRIP**